

# Einnova Solarline

*invented for solar*

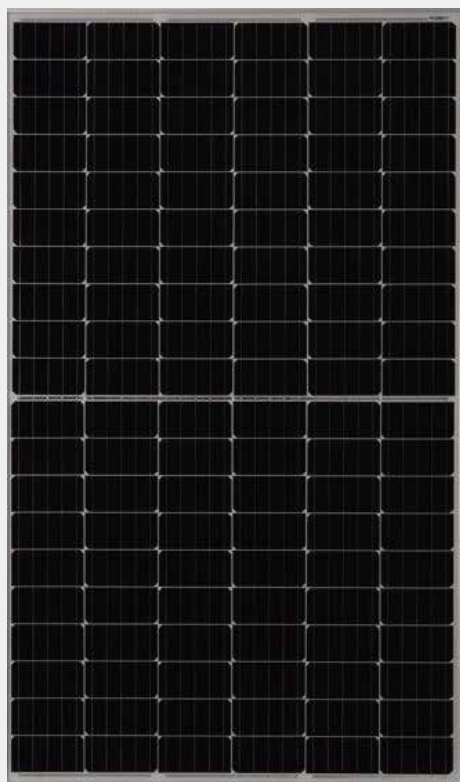

## Half Cut Mono Crystalline Solar Module

### ESM 485/490/495/500/505H

## KEY FEATURES



Excellent module efficiency up to: 21.50%



IP68 junction box for long-term weather endurance



Heavy snow load up to 5400 Pa, wind load up to 3600 Pa



PID: Selected material and stringent quality system ensure PID free



Applicable to harsh environment of deserts, farmlands and seashores



Much lower risk of Hot Spot

## CERTIFICATE



## WARRANTY



Linear power output warranty  
 -12 years minimum 92% power output  
 -30 years minimum 83% power output



Product warranty on materials and workmanship  
 According to the applicable Einnova Solarline Limited Warranty Statement

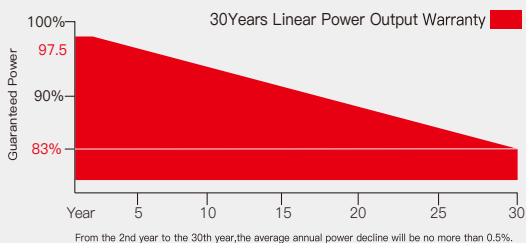

China Jiangsu  
International Group Ltd.

5 West Beijing Road,  
Nanjing, 210008, China

+86-(0)25-84792033  
+86-(0)25-84705923

info@einnova-solarline.com  
www.einnova-solarline.com

EN

# Ennova Solarline

*invented for solar*

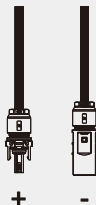
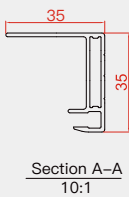
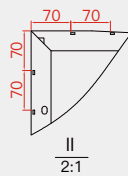
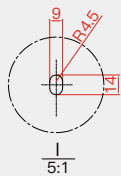
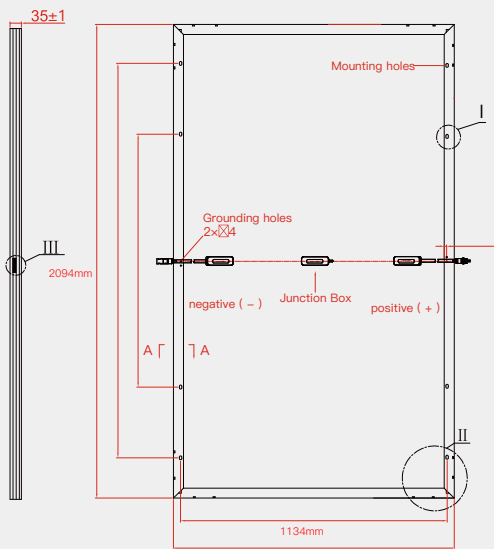
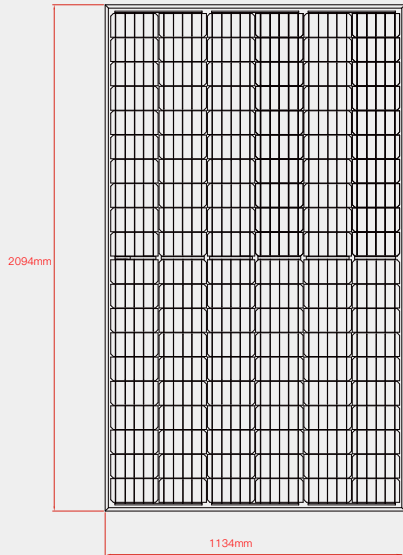

## IV CURVE

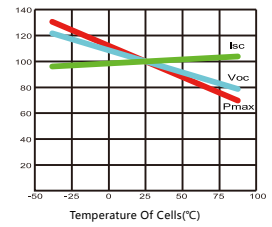
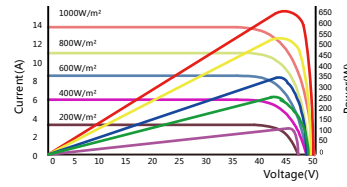

| ELECTRICAL Specification    | Unit | ESM-485H                 | ESM-490H | ESM-495H | ESM-500H | ESM-505H |
|-----------------------------|------|--------------------------|----------|----------|----------|----------|
| Maximum Power (Pmax)        | W    | 485                      | 490      | 495      | 500      | 505      |
| Module Efficiency           | %    | 20.6                     | 20.90    | 21.10    | 21.30    | 21.50    |
| Open Circuit Voltage (Voc)  | V    | 45.10                    | 45.25    | 45.40    | 45.55    | 45.70    |
| Short Circuit Current (Isc) | A    | 13.67                    | 13.74    | 13.82    | 13.90    | 13.97    |
| Maximum Power Voltage (Vmp) | V    | 37.93                    | 38.08    | 38.23    | 38.38    | 38.53    |
| Maximum Power Current (Imp) | A    | 12.79                    | 12.87    | 12.95    | 13.03    | 13.11    |
| Maximum System Voltage      | V    | ICE 15.00VDC/UL1500(VDC) |          |          |          |          |
| Maximum Series Fuse Rating  | A    | 25                       |          |          |          |          |

| ELECTRICAL DATA@NOCT | ESM-485H | ESM-490H | ESM-495H | ESM-500H | ESM-505H |
|----------------------|----------|----------|----------|----------|----------|
| Pmax [W]             | 367      | 370      | 374      | 378      | 382      |
| Vmp[V]               | 35.67    | 35.76    | 35.84    | 35.93    | 36.02    |
| Imp [A]              | 10.28    | 10.36    | 10.44    | 10.52    | 10.60    |
| Voc[V]               | 42.30    | 42.43    | 42.58    | 42.72    | 42.86    |
| Isc[A]               | 11.06    | 11.13    | 11.20    | 11.27    | 11.34    |

NOCT:Irradiance:800W/m<sup>2</sup>, Ambient Temperature:20°C,Air Mas:1.5,Wind Speed:1m/s

| MECHANICAL SPECIFICATIONS |   |
|---------------------------|---|
| Solar Cell Type           | Monocrystalline 182"                    |
| Number of Cells           | 132pcs                                  |
| Module Size               | 2094*1134*35mm                          |
| Weight                    | 25.1kg                                  |
| Glass                     | 3.2mm tempered glass                    |
| Back Sheet                | White or Black                          |
| Frame                     | Anodized aluminum alloy,silver or black |
| Junction Box              | IP68,three diodes                       |
| Quantity of Diodes        | 3pcs                                    |
| Cable                     | 4.0mm <sup>2</sup> 1000mm               |
| Connector                 | MC4 Compatible                          |
| Wind/Snow Load            | 3600pa/5400pa                           |

| TEMPERATURE CHARACTERISTIC                  |             |
|---|-------------|
| NMOT (Nominal Module Operating Temperature) | 45°C (±2°C) |
| Temperature Coefficient of P <sub>MAX</sub> | - 0.36%/°C  |
| Temperature Coefficient of U <sub>OC</sub>  | - 0.26%/°C  |
| Temperature Coefficient of I <sub>SC</sub>  | 0.04%/°C    |

| MAXIMUM RATINGS         |                                |
|-------------------------|--------------------------------|
| Operational Temperature | -40 to +85°C                   |
| Maximum System Voltage  | 1500V DC(IEC)<br>1500V DC (UL) |
| Max Series Fuse Rating  | 20A                            |
| Snow Load               | 5400 Pa (3600 Pa)              |
| Wind Load               | 3600 Pa (1600 Pa)              |

| PACKAGING CONFIGURATION |        |
|-------------------------|--------|
| Modules per box:        | 30pcs  |
| Number per 20GP:        | 150pcs |
| Modules per 40' HQ:     | 660pcs |

\*design load with safety factor 1.5  
(DO NOT connect Fuse in Combiner Box with two or more strings in parallel connection)